

INDEX OF SHEETS

SHEET NO.	
1	TITLE SHEET
2	PLAN AND PROFILE
3-6	BRIDGE PLANS
RD611	KDOT GUARDRAIL POST DETAILS
RD618	KDOT END TERMINAL II

PRAIRIE BAND POTAWATOMI NATION

PLAN AND PROFILE OF PROPOSED

BRIDGE REPLACEMENT G ROAD

NATIONAL BRIDGE INVENTORY NUMBER - 0000B04862T0205

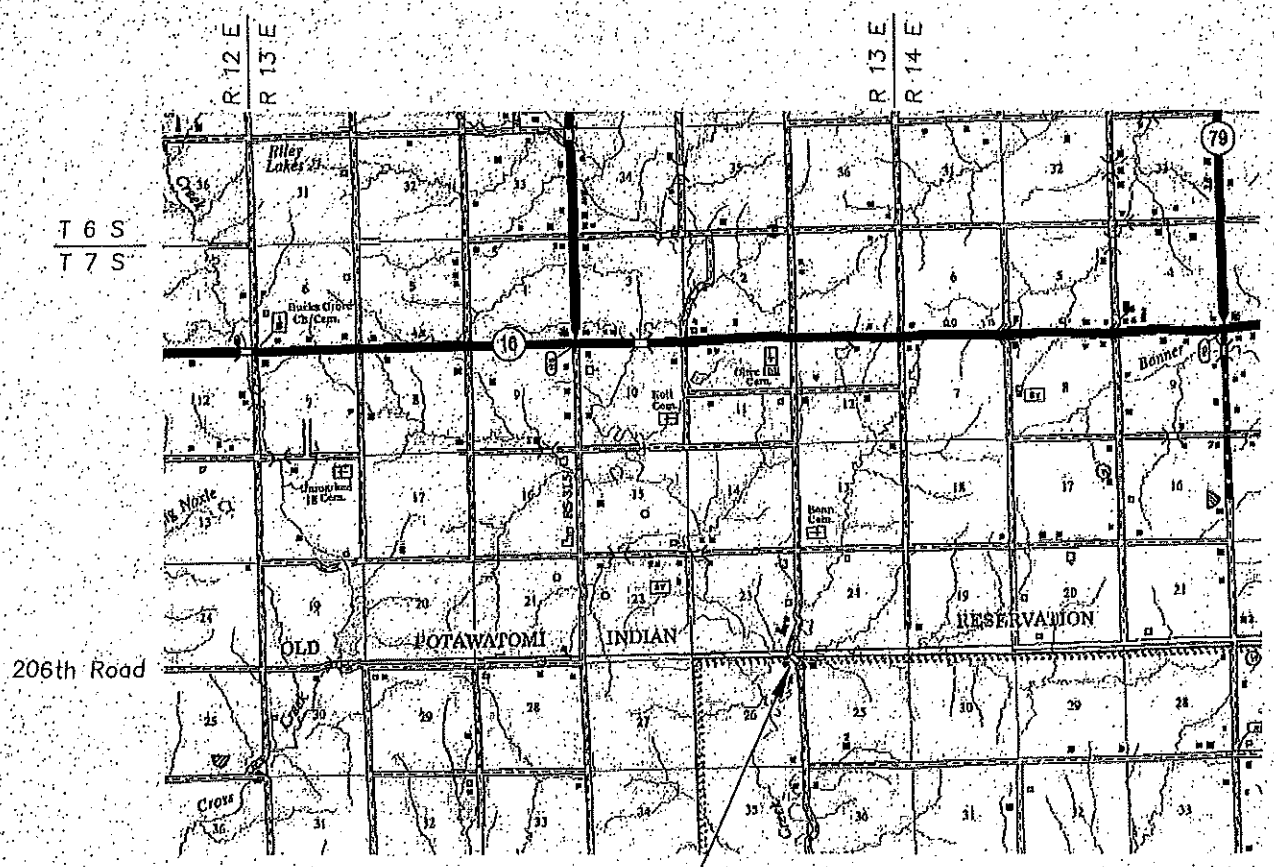

STATION: 9+92 - 10+62
BRIDGE G-205
STEEL GIRDER
SINGLE SPAN 70'-0"

U.S. DEPARTMENT OF THE INTERIOR
BUREAU OF INDIAN AFFAIRS
RECOMMENDED FOR APPROVAL

[Signature] 4/4/23
REGIONAL ROAD ENGINEER DATE

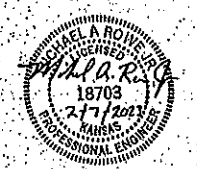

Plans By:



The 2015 edition of the Kansas Standards Specifications for state road and bridge construction apply to this project.

This project will be closed to all traffic during construction by Washington County. Traffic control will be maintained by the Contractor. This shall be subsidiary to other bid items of the project.

CONVENTIONAL SIGNS

FENCE	
GUARDRAIL	
TRAVEL WAY	
DIKE	
CULVERT	
DROP INLET & STORM SEWER	
ACCESS CONTROL	
POWER POLE	
TELEPHONE POLE	
MAILBOX	
RAILROAD TRACKS	
MARSH	
TREE - CONIFEROUS	
TREE DECIDUOUS	
STREAM or CREEK	

PBPN assumes no responsibility for the location of the utilities and any reference to utilities on the plans is approximate. Any utility damaged by the contractor during construction shall be repaired at the contractor's expense.

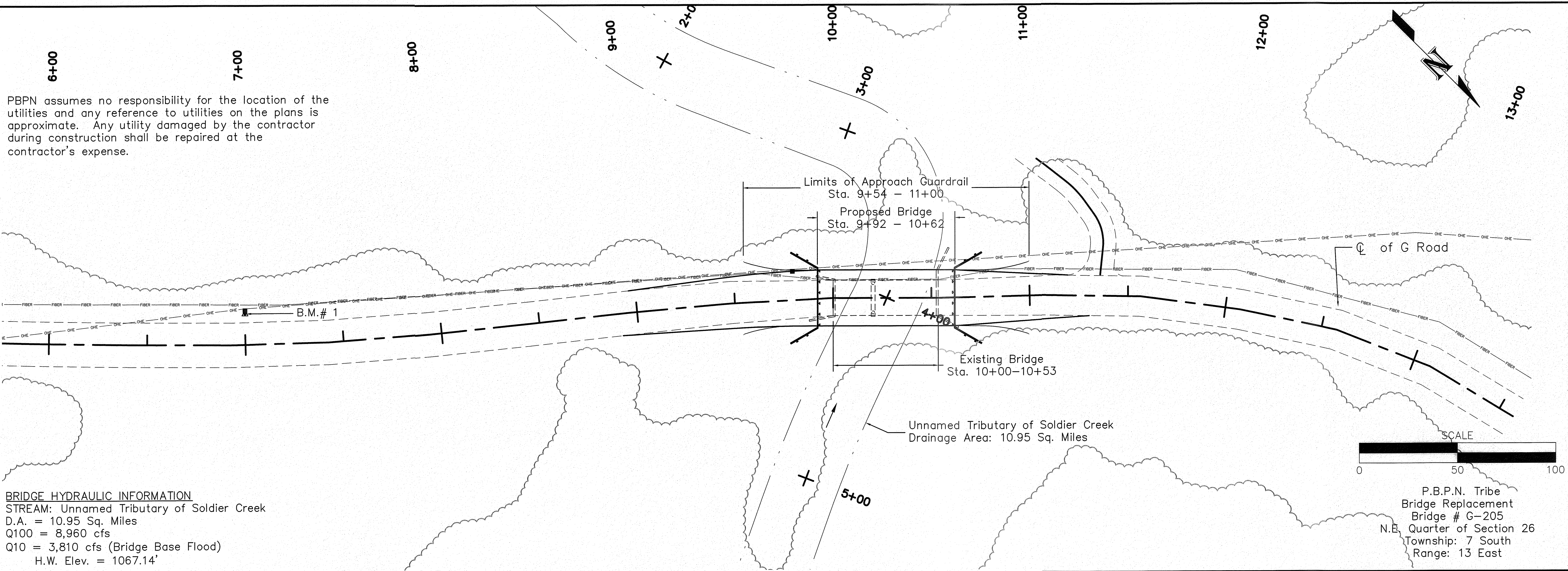

BRIDGE HYDRAULIC INFORMATION
 STREAM: Unnamed Tributary of Soldier Creek
 D.A. = 10.95 Sq. Miles
 Q100 = 8,960 cfs
 Q10 = 3,810 cfs (Bridge Base Flood)
 H.W. Elev. = 1067.14'

P.B.P.N. Tribe
 Bridge Replacement
 Bridge # G-205
 N.E. Quarter of Section 26
 Township: 7 South
 Range: 13 East

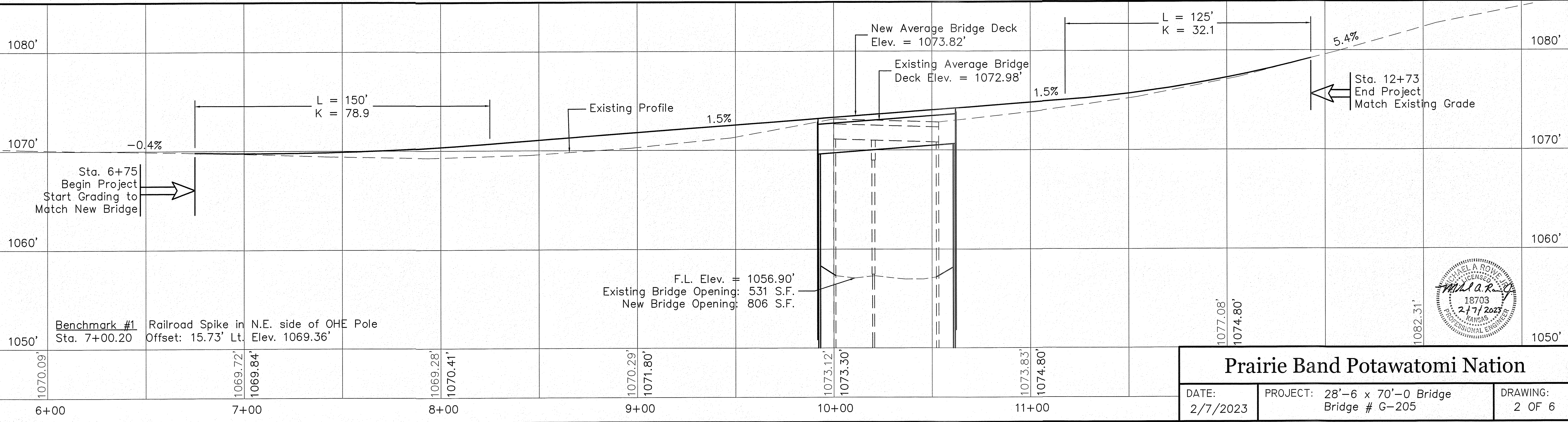

Prairie Band Potawatomi Nation		
DATE: 2/7/2023	PROJECT: 28'-6 x 70'-0 Bridge Bridge # G-205	DRAWING: 2 OF 6

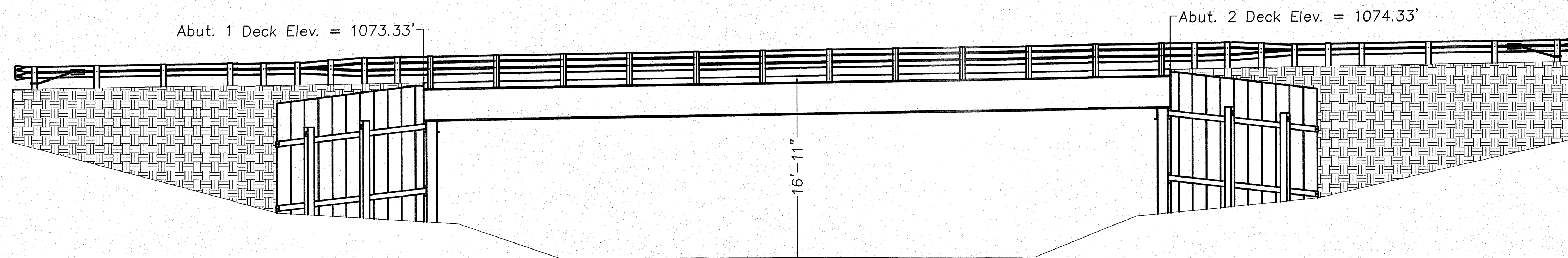
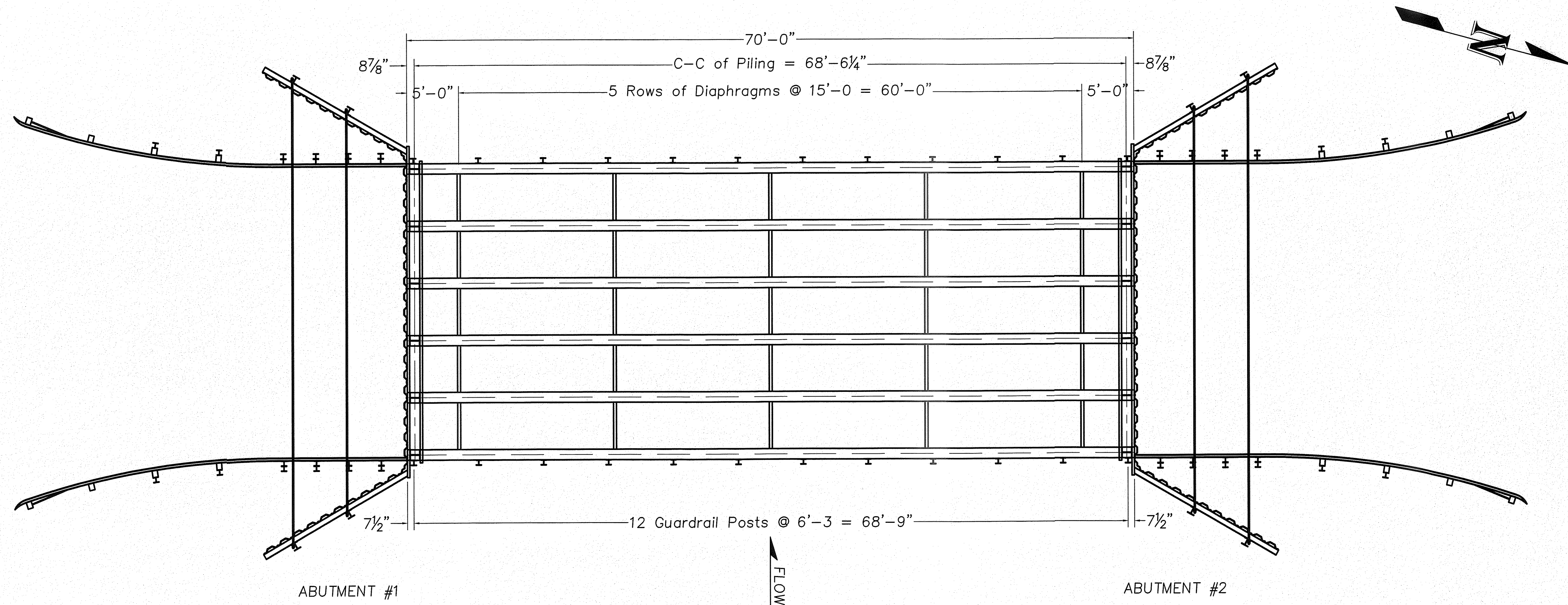

BRIDGE LAYOUT

NOTES:

- 1.) H-Piling at Abutments shall be HP12x53.
- 2.) H-Piling at Wings shall be HP8x36.
- 3.) Sheet Piling shall be 7 Gage and conform to ASTM A-570 Grade 50.
- 4.) Girders shall be W36X160 - 70'-0. Girders, diaphragms, and clips shall conform to ASTM A588 Grade 50. Bolts connecting weathering steel shall conform to Grade A325 TYPE III.
- 5.) All Reinforcing bar shall be ASTM A615 Grade 60.
- 6.) All other material shall be ASTM A36.
- 7.) Turnbuckles shall conform to ASTM A668 Class C.
- 8.) Concrete deck shall be class 4.0 (AE)(SA) with a 28-Day strength of 4,000 psi. A quantity of 45 Cubic Yards is required for the deck.
- 9.) Guardrail shall consist of Galvanized Thrie Beam.
- 10.) The bridge is designed to the Latest Version of the AASHTO LRFD BRIDGE DESIGN SPECIFICATIONS.

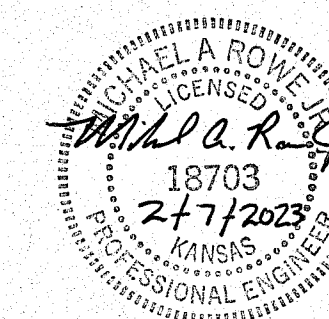

BRIDGE LOCATION:
From the intersection of Hwy 16 & Hwy 62, travel 2 miles east on Hwy 16, travel 3.1 miles south on County Road G to jobsite.

Prairie Band Potawatomi Nation

DATE: 2/7/2023	PROJECT: 28'-6 x 70'-0 Bridge Bridge # G-205	DRAWING: 3 OF 6
-------------------	---	--------------------

NOTES:

Steel piling at Abutments shall be HP12x53.
 Estimated Abutment piling length is 50'-0" long and shall be driven to design pile bearing of 42 ton per pile.
 Steel piling at Wings shall be HP8x36, 30'-0".

All steel sheet piling shall be 7 gage & conform to ASTM A-570, Grade 50.
 Abutment sheet piling shall be 24'-0" long.

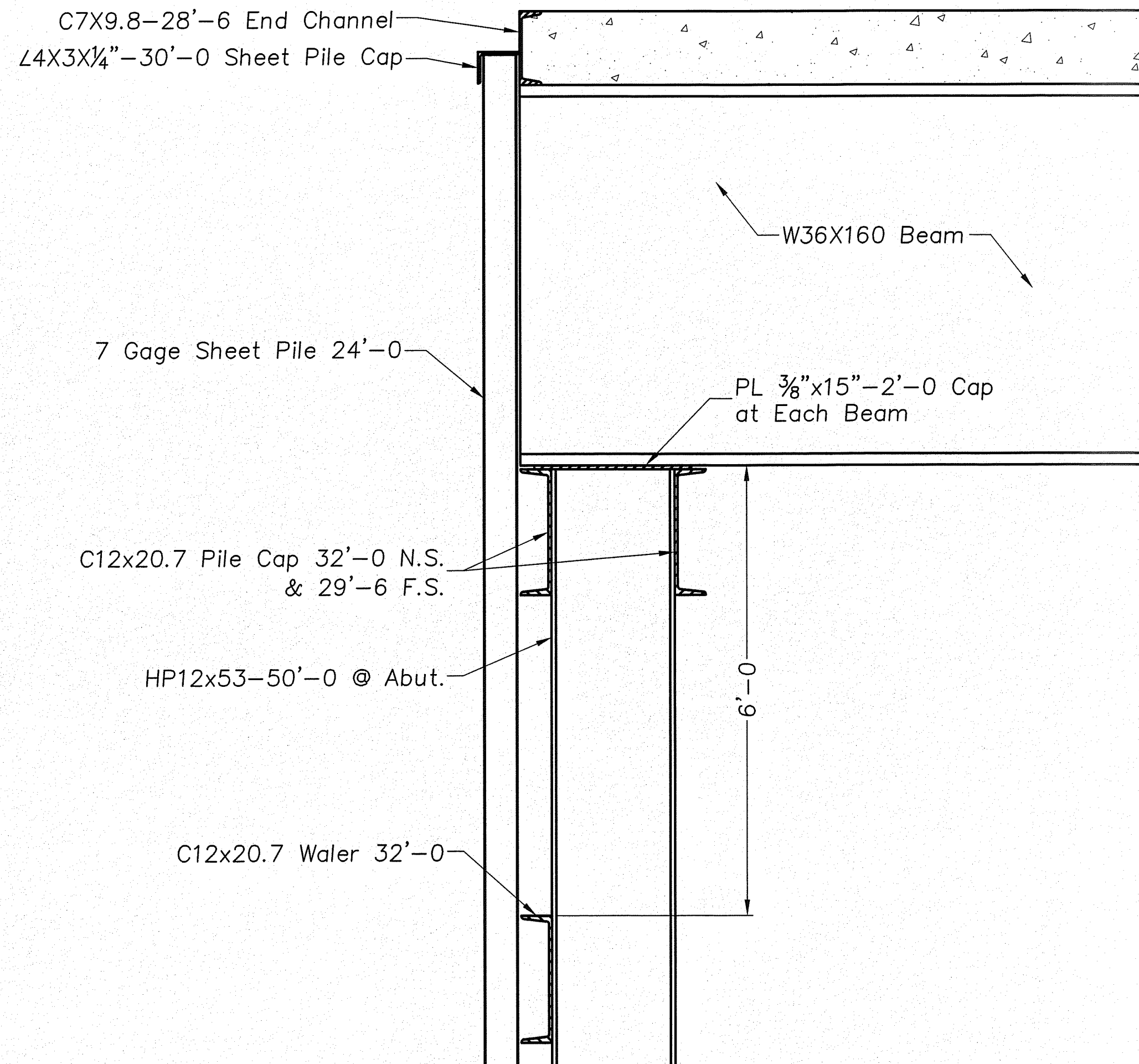

ABUTMENT DETAIL

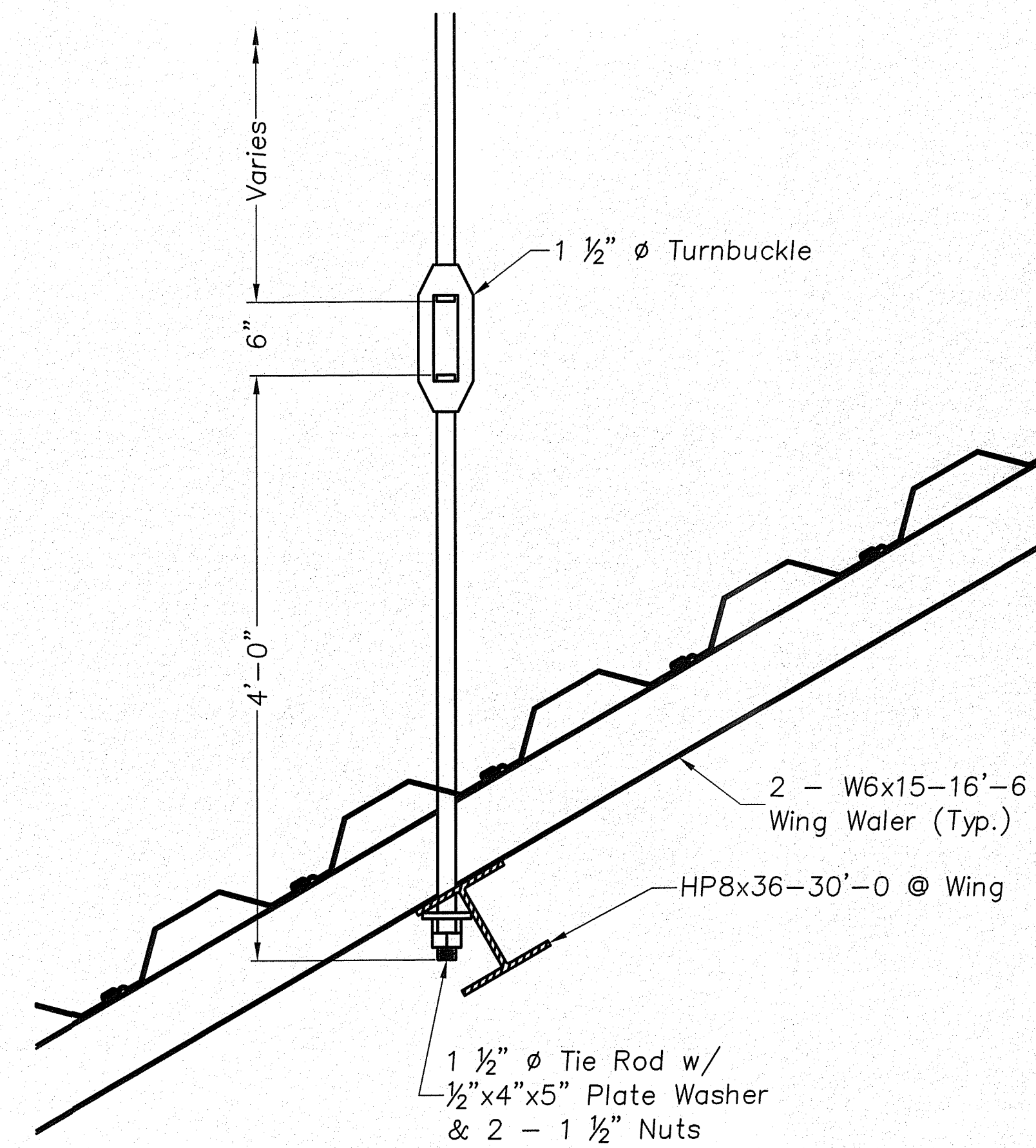

WING DETAIL

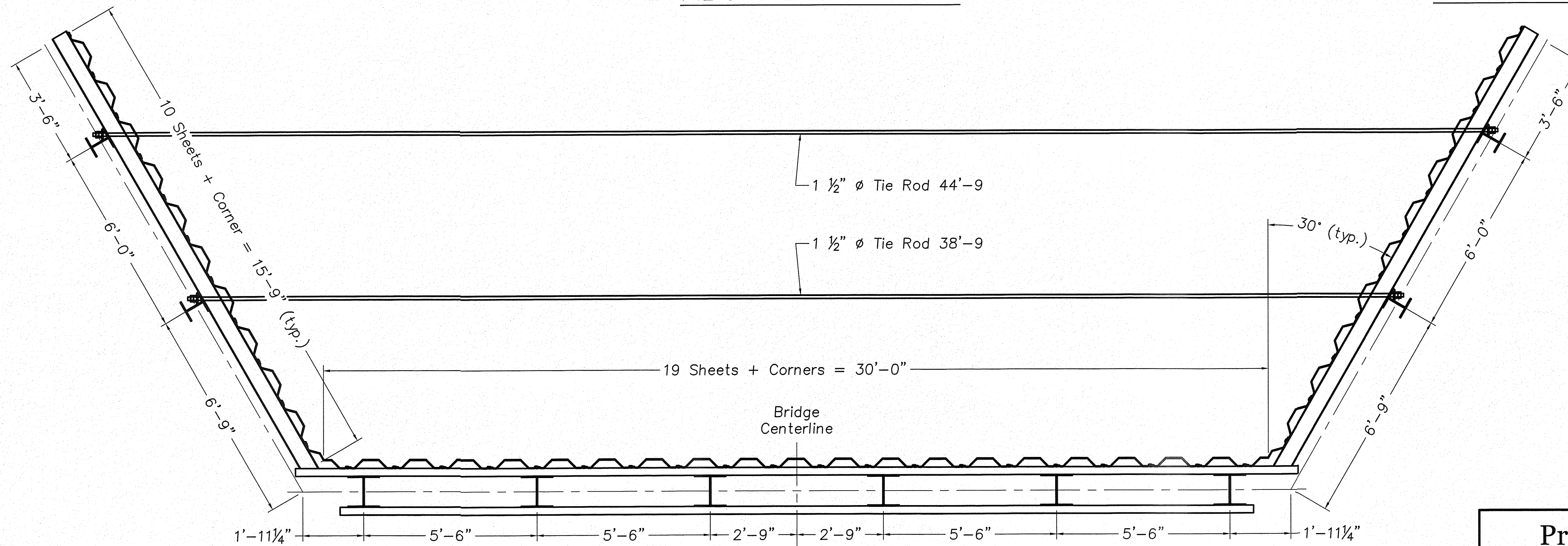

ABUTMENT LAYOUT

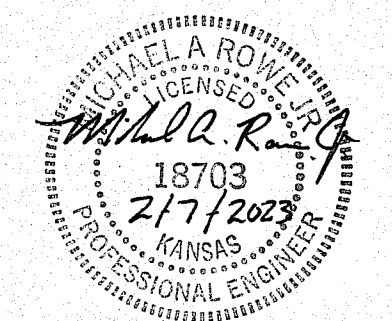

Prairie Band Potawatomi Nation		
DATE: 2/7/2023	PROJECT: 28'-6" x 70'-0" Bridge Bridge # G-205	DRAWING: 4 OF 6

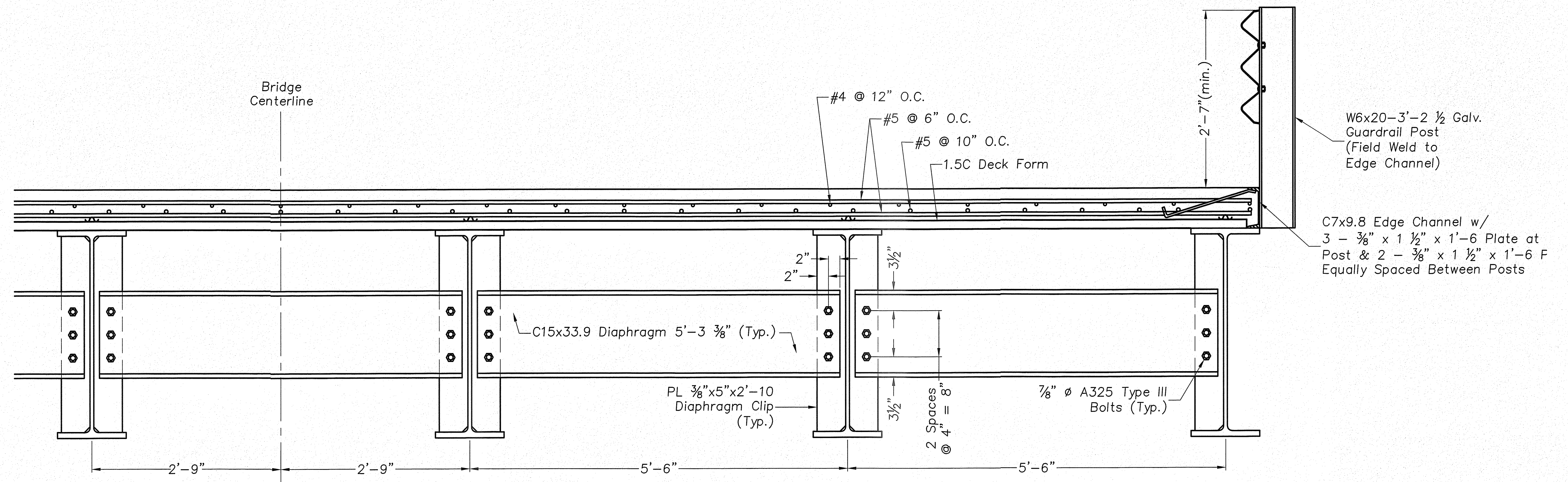

SUPERSTRUCTURE DETAIL

NOTES:

The Girders shall be W36x160-70'-0. Girders, Diaphragms, and Clips shall conform to ASTM A588 Grade 50, weathering steel.

All bolts for Diaphragms shall be 7/8" ø. Bolts connecting to weathering steel shall conform to Grade A325 type III.

The girders for this bridge are not designed to resist any torsional or lateral forces due to temporary construction loads. The Contractor must provide any temporary bracing necessary to support the girder web and flanges against all torsional or lateral forces resulting from construction loads.

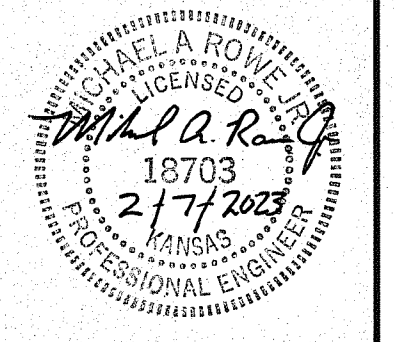

Prairie Band Potawatomi Nation		
DATE: 2/7/2023	PROJECT: 28'-6 x 70'-0 Bridge Bridge # G-205	DRAWING: 5 OF 6

NOTES:

Typical guardrail approach shall be placed on all four corners of the bridge.
Reference KDOT standard drawings
RD611 - Guardrail Post Detail
RD618 - End Terminal II

The Contractor will install approach transitions post, guardrail, and end terminal after the Prairie Band Potawatomi Nation has backfilled and compacted the material behind the backwalls.

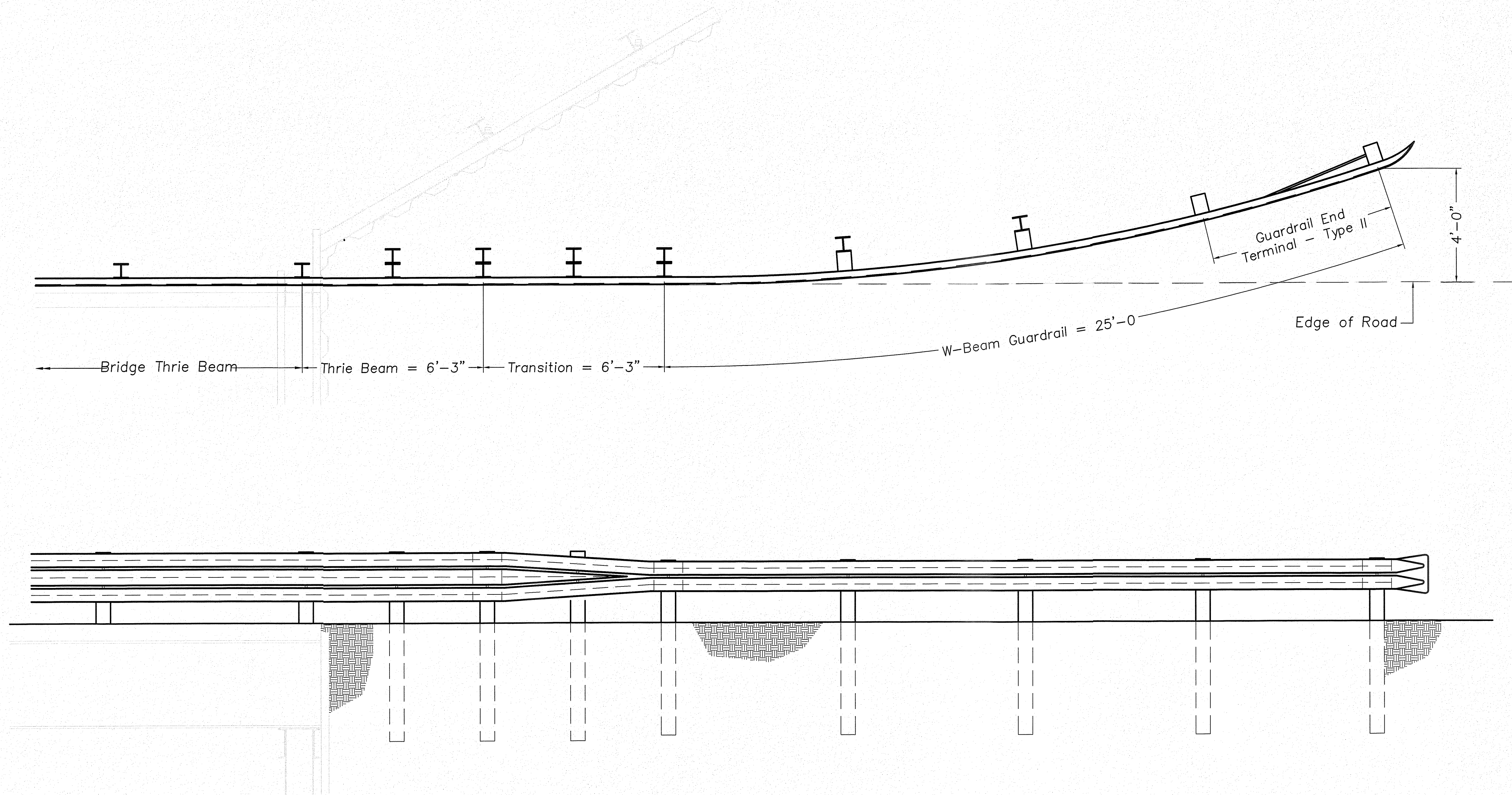

TYPICAL GUARDRAIL APPROACH

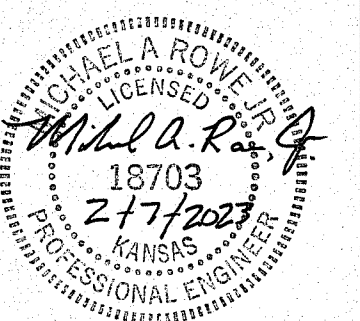

Prairie Band Potawatomi Nation

DATE: 2/7/2023	PROJECT: 28'-6 x 70'-0 Bridge Bridge # G-205	DRAWING: 6 OF 6
-------------------	---	--------------------